

IMPORTANT SAFETY INSTRUCTIONS

1. Read these Instructions.
 2. Keep these Instructions.
 3. Heed all Warnings.
 4. Follow all instructions.
 5. Do not use this apparatus near water.
 6. Clean only with a dry cloth.
 7. Do not block any ventilation openings. Install in accordance with the manufacturer's instructions.
 8. Do not install near any heat sources such as radiators, heat registers, stoves, or other apparatus (including amplifiers) that produce heat.
 9. Do not defeat the safety purpose of the polarized or grounding - type plug. A polarized plug has two blades with one wider than the other. A grounding type plug has two blades and a third grounding prong. The wide blade or the third prong are provided for your safety. When the provided plug does not fit into your outlet, consult an electrician for replacement of the obsolete outlet.
 10. Protect the power cord from being walked on or pinched particularly at plugs, convenience receptacles, and the point where they exit from the apparatus.
 11. Only use attachments/accessories specified by the manufacturer.
 12. Use only with a cart, stand, tripod, bracket, or table specified by the manufacturer, or sold with the apparatus. When a cart is used, use caution when moving the cart/apparatus combination to avoid injury from tip-over.
- 
13. Unplug this apparatus during lightning storms or when unused for long periods of time.
 14. Refer all servicing to qualified service personnel. Servicing is required when the apparatus has been damaged in any way, such as power-supply cord or plug is damaged, liquid has been spilled or objects have fallen into the apparatus, the apparatus has been exposed to rain or moisture, does not operate normally, or has been dropped.

WARNINGS AND PRECAUTIONS

- **CAUTION:** TO PREVENT ELECTRIC SHOCK, MATCH WIDE BLADE OF PLUG TO WIDE SLOT, FULLY INSERT.
- **WARNING:** To reduce the risk of fire or electric shock, do not expose this apparatus to rain or moisture.
- **AVERTISSEMENT:** Pour réduire le risque d'incendie ou de choc électrique, ne pas exposer cet appareil sous la pluie et l'humidité.
- **CAUTION:** Use of controls or adjustments or performance of procedures other than those specified may result in hazardous radiation exposure.
- **WARNING:** Changes or modifications to this unit not expressly approved by the party responsible for compliance could void the user's authority to operate the equipment.
- **WARNING:** Do not place the unit on top of any soft, porous, or sensitive surfaces to avoid damaging the surface. Use a protective barrier between the unit and surface to protect the surface.
- **WARNING:** Use of this unit near fluorescent lighting may cause interference regarding use of the remote. If the unit is displaying erratic behavior move away from any fluorescent lighting, as it may be the cause.
- **CAUTION:** Danger of explosion if battery is incorrectly replaced. Replace only with the same or equivalent type.
- **PRÉCAUTION:** Danger d'explosion si les piles sont remplacées de façon incorrecte. Remplacer les piles seulement par le même type de pile ou l'équivalent.
- **WARNING:** There is a danger of explosion if you attempt to charge standard Alkaline batteries in the unit. Only use rechargeable NiMH batteries.
- **WARNING:** The remote control's button cell battery contains mercury. Do not put in the trash, instead recycle or dispose of as hazardous waste.
- **WARNING:** Lithium batteries, like all rechargeable batteries are recyclable and should be recycled or disposed of in normal household waste. Contact your local government for disposal or recycling practices in your area. They should never be incinerated since they might explode.

Main plug is used as disconnect device and it should remain readily operable during intended use.

Do not mix old and new batteries.
Do not mix alkaline, standard (carbon-zinc), or rechargeable (ni-cad, ni-mh, etc) batteries.
No mezcle baterias viejas y nuevas.
No mezcle baterias alcalinas, estándar (carbono-zinc) o recargables (ni-cad, ni-mh, etc.).

CAUTION
RISK OF ELECTRIC SHOCK
DO NOT OPEN

WARNING: TO REDUCE THE RISK OF ELECTRIC SHOCK, DO NOT REMOVE COVER (OR BACK). NO USER-SERVICEABLE PARTS INSIDE. REFER SERVICING TO QUALIFIED SERVICE PERSONNEL.



The lightning flash with arrowhead symbol, within an equilateral triangle, is intended to alert the user to the presence of uninsulated "dangerous voltage" within the product's enclosure that may be of sufficient magnitude to constitute a risk of electric shock to persons.



The exclamation point within an equilateral triangle is intended to alert the user to the presence of important operating and maintenance (servicing) instructions in the literature accompanying the appliance.



This product utilizes a Class 1 laser to read Compact Discs. This laser Compact Disc Player is equipped with safety switches to avoid exposure when the CD door is open and the safety interlocks are defeated. Invisible laser radiation is present when the CD Player's lid is open and the system's interlock has failed or been defeated. It is very important that you avoid direct exposure to the laser beam at all times. Please do not attempt to defeat or bypass the safety switches.

FCC Warnings

NOTE: This equipment has been tested and found to comply with the limits for a Class B digital device, pursuant to Part 15 of the FCC Rules. These limits are designed to provide reasonable protection against harmful interference in a residential installation. This equipment generates, uses, and can radiate radio frequency energy and, if not installed and used in accordance with the instructions, may cause harmful interference to radio communications. However, there is no guarantee that interference will not occur in a particular installation. If this equipment does cause harmful interference to radio or television reception, which can be determined by turning the equipment off and on, the user is encouraged to try to correct the interference by one or more of the following measures:

- Reorient or relocate the receiving antenna.
- Increase the separation between the equipment and receiver.
- Connect the equipment into an outlet on a circuit different from that to which the receiver is connected.
- Consult the dealer or an experienced radio/TV technician for help.

Additional Warnings

- The apparatus shall not be exposed to dripping or splashing and that no objects filled with liquids, such as vases, shall be placed on apparatus.
L'appareil ne doit pas être exposé aux écoulements ou aux éclaboussures et aucun objet ne contenant de liquide, tel qu'un vase, ne doit être placé sur l'objet.
- Main plug is used as disconnect device and it should remain readily operable during intended use. In order to disconnect the apparatus from the mains completely, the mains plug should be disconnected from the mains socket outlet completely.
La prise du secteur ne doit pas être obstruée ou doit être facilement accessible pendant son utilisation. Pour être complètement déconnecté de l'alimentation d'entrée, la prise doit être débranchée du secteur.
- Battery shall not be exposed to excessive heat such as sunshine, fire or the like.
Les piles ne doivent pas être exposées à de forte chaleur, tel qu'à la lumière du soleil, au feu ou autres choses de semblable.
- Caution marking is located at the rear of the apparatus.
Les marquages sont inscrits de derrière de l'appareil.
- Caution marking is located at the rear of the apparatus.
Les marquages sont inscrits de derrière de l'appareil.
- The marking information is located at the bottom of apparatus.
Les précautions d'emploi sont inscrites en bas de l'appareil.
- The marking information is located at the bottom of apparatus.
Les précautions d'emploi sont inscrites en bas de l'appareil.

SETUP

Power

Plug the attached AC cord into a standard AC power outlet to power the clock radio.

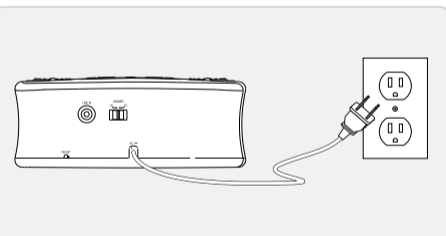

Battery Backup

Requires one 9V battery (not included)

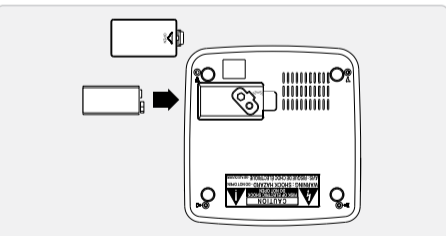

INTRODUCTION

DISPLAY

PM INDICATOR
Illuminates when the time is set in the PM.

AL INDICATOR
Illuminates when the alarm is set and active.

BUZZER/AUTO/OFF/ON
Adjust to set the alarm to BUZZER or AUTO (radio or iPod), or to turn the clock radio OFF or ON.

CLOCK SET
Press and hold to adjust the time.

VOLUME
Turn to adjust the volume.

SNOOZE
Press, after the alarm sounds, to delay the alarm for an additional 9 minutes.

LINE INPUT (3.5mm)

FM WIRE ANTENNA

DOCK FOR IPOD

HOUR/MIN
Press to adjust the hour and minute when setting the clock, alarm, or sleep timer.

AL SET
Press and hold to set the alarm.

FM/AM/iPod
Adjust to set the clock radio to FM, AM, or iPod mode.

SLEEP
Press and hold to set the sleep timer.

TUNING
Turn to adjust the AM or FM radio station.

PLAY/PAUSE
Press to play or pause a docked iPod.

SKIP/SEARCH
Press to skip between tracks on a docked iPod. Press and hold to search through an individual track on a docked iPod.

DIMMER
Use to adjust the brightness of the display.

CLOCK

Setting the Clock

- 1 Press and hold the **CLOCK SET** button.
- 2 While holding the **CLOCK SET** buttons, press the **HOURL** and **MIN** buttons to adjust the hour and minute.
- 3 Release the **CLOCK SET** button to finish setting the clock.

Setting the Alarm

- 1 Press and hold the **ALARM SET** button.
- 2 While holding the **ALARM SET** buttons, press the **HOURL** and **MIN** buttons to adjust the hour and minute.
- 3 Release the **ALARM SET** button to finish setting the alarm time.
- 4 Adjust the **VOLUME** to the desired level.
- 5 Adjust the **BUZZER/AUTO/OFF/ON** to BUZZER to wake to the buzzer, or to AUTO to wake to the radio or iPod.
- 6 If waking to the radio or iPod, adjust the **FM/AM/iPod** switch to the desired setting.

Setting the Sleep Timer

- 1 Adjust the **BUZZER/AUTO/OFF/ON** switch to AUTO.
- 2 While listening to the radio or a docked iPod press and hold the **SLEEP** button.
- 3 While holding the **SLEEP** button, press the **HOURL** and **MIN** buttons to adjust the hour and minute to the desired time.
- 4 Once the desired time is set, release the **SLEEP** button to finish setting the sleep timer.
- 5 After the set time has expired the clock radio will automatically power off.

iPod

Docking an iPod

- 1 Locate the numbered bracket that fits the iPod model that will be docked.
Each included bracket has a number on it, indicating which iPod model that bracket is compatible with. See the separate bracket chart page to identify which bracket is needed.
- 2 Snap the bracket into place over the iPod connector in the dock for iPod.
- 3 Connect the iPod to the connector inside the Dock for iPod.
When the clock radio is plugged in, using AC power, the docked iPod will charge.

Playing an iPod

- 1 Follow the instructions for DOCKING AN IPOD.
- 2 Adjust the **BUZZER/AUTO/OFF/ON** switch to AUTO or ON.
- 3 Adjust the **FM/AM/iPod** switch to iPod.
- 4 Press the **PLAY/PAUSE** button to begin playing the docked iPod.
When the LINE INPUT is connected, AM and FM radio or a docked iPod will not play through the clock radio.

Radio and Line Input

Playing the AM or FM Radio

- 1 Adjust the **BUZZER/AUTO/OFF/ON** switch to AUTO or ON.
- 2 Adjust the **FM/AM/iPod** switch to FM or AM.
- 3 Turn the **TUNING** dial to adjust the AM or FM radio station.
When the LINE INPUT is connected, AM and FM radio or a docked iPod will not play through the clock radio.

Using the Line Input

- Requires a 3.5mm line input cable (not included)
- 1 Connect an MP3 player to the **LINE INPUT** using a 3.5mm line input cable.
 - 2 Adjust the **BUZZER/AUTO/OFF/ON** switch to AUTO or ON.
 - 3 Use the native controls on the connected MP3 player to control audio played through the clock radio.
When the LINE INPUT is connected, AM and FM radio or a docked iPod will not play through the clock radio.

LIMITED 90 DAY WARRANTY

Limited 90 Day Warranty

The Manufacturer warrants this product to the original purchaser to be free from defects in material and workmanship, under normal conditions, for a period of 90 days from date of original purchase.

The Manufacturer agrees, at its option during the warranty period, to repair any defect in material or workmanship or to furnish a repaired or refurbished product of equal value in exchange without charge. Such repair or replacement is subject to verification of the defect or malfunction and proof of purchase as confirmed by showing a copy of the original dated sales receipt.

For any questions regarding your product or this warranty call: **1-888-999-4215**

This warranty does *not* cover:

- Any product which has been subject to damage due to an act of God, misuse, neglect, accident, abuse, commercial use, or modification of, or to, any part of the product, including the antenna.
- Damage to external media such as DVD, CD, iPod, iPhone, MP3 players, and/or memory devices.
- Damage due to improper operation or maintenance, connection to improper voltage supply, or attempted repair by anyone other than the Manufacturer.
- Re-manufactured units, product sold AS IS or closeout product.

Under no circumstances shall the Manufacturer be liable for any loss (direct, indirect, incidental, foreseen, unforeseen, special or consequential) or for any damage arising out of, or in connection with, the use of this product.

This warranty is valid only in the United States and grants specific legal rights. You may also have other rights which vary from state to state.

The customer is responsible for costs incurred when shipping a return back to DPI, Inc.

NOTE: For products that contain internal memory for storage of music, data, etc., the amount of memory your operating system reports may vary from the stated memory of this device.

IMPORTANT: DO NOT RETURN THIS UNIT TO THE RETAIL STORE FOR SERVICE. INSTEAD, CALL 1-888-999-4215 FOR WARRANTY SERVICE INSTRUCTIONS.

Garantie limitée de 90 jours

Le fabricant garantit ce produit à l'acheteur original pour être exempt de défauts de matériaux et de fabrication, dans des conditions normales, pour une période de 90 jours à compter de la date d'achat originale.

Le fabricant s'engage, à son gré au cours de la période de garantie, de réparer tout défaut de matériel ou de fabrication ou de fournir un produit réparé ou rénové produit de valeur équivalente en échange sans frais. réparation ou remplacement est soumis à la vérification du défaut ou de mauvais fonctionnement et une preuve d'achat ainsi que le confirme en montrant une copie de l'original du reçu de vente daté.

Pour toute question concernant votre produit ou de cet appel de garantie: **1-888-999-4215**

Cette garantie ne couvre pas:

- Tout produit qui a été soumis aux dommages résultant d'un acte de Dieu, abus, négligence, accident, abus, utilisation commerciale, ou la modification de ou à destination d'une partie du produit, y compris l'antenne.
- Les dommages sur des supports externes tels que les DVD, CD, iPod, iPhone, lecteurs MP3, et / ou des dispositifs à mémoire.
- Les dommages dus à un mauvais fonctionnement ou l'entretien, la connexion à une alimentation inappropriée, ou tentative de réparation par quiconque autre que le fabricant.
- unités Re-construit, produit vendu TEL QUEL ou le produit clôture.

En aucun cas, le fabricant peut être responsable de toute perte (directs, indirects, accessoires, prévues et imprévues, particuliers ou consécutifs) ou de tout dommage découlant de, ou en relation avec l'utilisation de ce produit.

Cette garantie est valable uniquement aux États-Unis et des subventions des droits légaux spécifiques. Vous pouvez également avoir d'autres droits qui varient d'état à l'autre.

Le client est responsable des frais encourus lors de l'expédition d'un retour vers le DPI, Inc

NOTE: Pour les produits qui contiennent la mémoire interne pour le stockage de musique, de données, etc, la quantité de mémoire de votre système d'exploitation des rapports peut varier de la mémoire à déclaré de ce dispositif.

IMPORTANT: NE PAS RETOURNER L'APPAREIL AU MAGASIN DE DÉTAIL POUR LE SERVICE. APPELEZ PLUTÔT 1-888-999-4215 POUR INSTRUCTIONS SERVICE DE GARANTIE.

90 días de garantía limitada

El fabricante garantiza que este producto al comprador original de estar libres de defectos en materiales y mano de obra, en condiciones normales, durante un período de 90 días a partir de la fecha de compra original.

El fabricante está de acuerdo, a su elección durante el período de garantía, para reparar cualquier defecto de material o mano de obra o proporcionar a un producto reparado o restaurado de igual valor a cambio sin cargo alguno. Dicha reparación o sustitución está sujeta a la verificación del defecto o mal funcionamiento y prueba de compra como se confirma al mostrar una copia de la factura original de venta.

Para cualquier pregunta relacionada con su producto o esta garantía, llame: **1-888-999-4215**

Esta garantía no cubre:

- Cualquier producto que haya sido expuestas a sufrir daños debido a un acto de Dios, mal uso, negligencia, accidente, abuso, uso comercial o modificación, o de cualquier parte del producto, incluyendo la antena.
- El daño a medios externos como DVD, CD, iPod, iPhone, reproductores de MP3, y / o dispositivos de memoria.
- Los daños provocados por una operación o el mantenimiento, la conexión a un voltaje incorrecto, o intento de reparación por cualquiera que no sea el Fabricante.
- Re unidades de fabricación, los productos vendidos TAL COMO ESTÁN o producto de la liquidación.

En ningún caso el fabricante será responsable de cualquier pérdida (directa, indirecta, incidental, previsto e imprevisto, especial o consecuente) o por cualquier daño que surja de o en conexión con el uso de este producto.

Esta garantía es válida sólo en los Estados Unidos y otorga derechos legales específicos. Usted también puede tener otros derechos que varían de estado a estado.

El cliente es responsable por los costes de envío cuando se volvía a utilizar el DPI, Inc.

NOTA: Para los productos que contienen la memoria interna para almacenamiento de música, datos, etc, la cantidad de memoria el sistema operativo informes pueden diferir de los previstos por la presente la memoria del dispositivo.

IMPORTANTE: NO DEVUELVA ESTE TEMA A LA TIENDA POR MENOR POR EL SERVICIO. LLAME A 1-888-999-4215 DE INSTRUCCIONES DE SERVICIO DE GARANTÍA.

COMPANY INFORMATION

Green Initiative

Environmental Commitment to 'Protect for Today and Sustain for Tomorrow'

2009 marks the official launch of DPI, Inc.'s corporate campaign for a greener and cleaner world. DPI and its four brands, iLive, WeatherX, Capri, and GPX, are building upon environmental initiatives introduced at all of their facilities to help formulate and sustain significant and important conservation efforts within its manufacturing and marketing communities. In addition to targeting and selecting energy efficient product features, and structuring 'green office' procedures, other initial program efforts include:

- Reduction of all packaging sizes
- Recyclable plastics for clamshell packages, with a plan to eventually replace plastic with recyclable paper
- Recycled fiber board in place of the polyfoam in packing boxes
- Recycled plastics in place of the virgin material in product construction

International Support

To download this User's Guide in English, Spanish, or French, visit the support section at www.gpx.com.

Para transferir esta guía de usuario en inglés, español, o francés, visite la sección de la ayuda en www.gpx.com.

Pour télécharger ce guide de l'utilisateur en anglais, espagnol, ou français, visitez la section de soutien chez www.gpx.com.

Contact Information

Phone: 1-888-999-4215

Email: prodinfo@gpx.com

Parts Email: partinfo@dpi-global.com

Website: www.gpx.com